

Wohnfläche	
Wohnen/Essen/ Kochen	ca. 16,38 m <sup>2</sup>
Schlafen	ca. 11,56 m <sup>2</sup>
Duschbad	ca. 4,55 m <sup>2</sup>
Diele	ca. 2,21 m <sup>2</sup>
Abstellfläche (AF)	ca. 1,09 m <sup>2</sup>
Terrasse (ca. 8,40 m <sup>2</sup> ) zu 1/2	ca. 4,20 m <sup>2</sup>
<b>Gesamt</b>	<b>ca. 39,99 m<sup>2</sup></b>

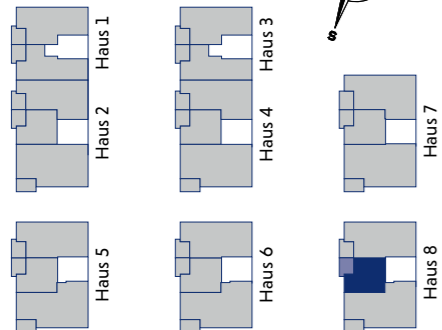

Klötzlmüllerstraße

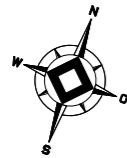
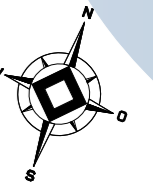
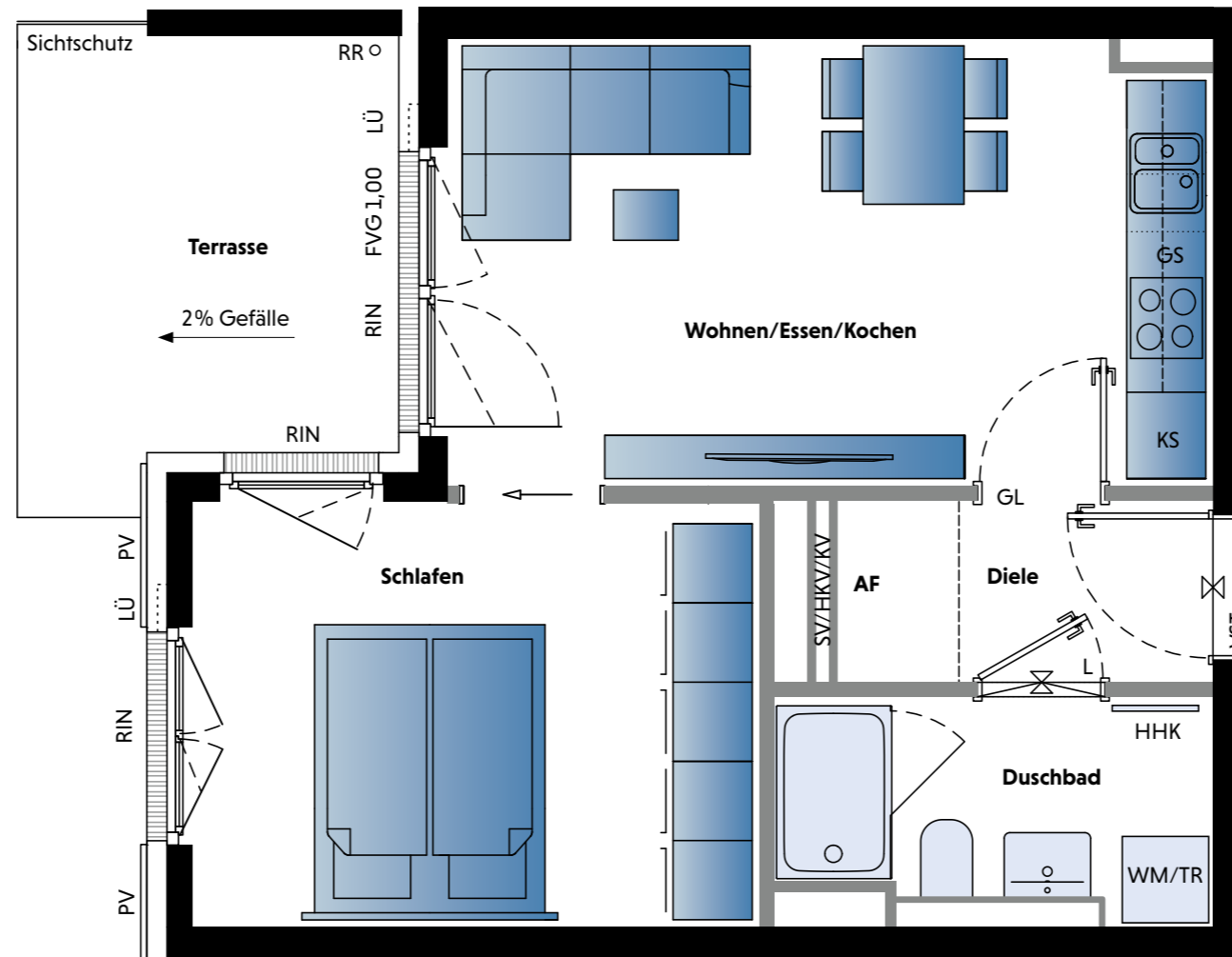

Maßstab 1 : 50